

# Antenna-Railway-Indoor-4W

## Railway Indoor Antenna with 4x4 MIMO WLAN + EN50155 + 3m Cable

Vertical and cross polarized dual-band antenna for signal enhancement in WLAN networks.

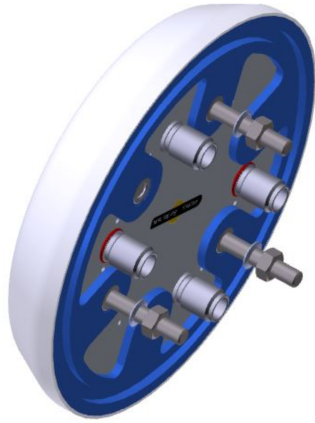

### Keyfeatures

<b>WiFi / WLAN</b>	MIMO 2.4 / 5 GHz
<b>Railway</b>	EN50155, EN45545
<b>Coach</b>	ECE R118

### Specifications

<b>WiFi / WLAN</b>	<b>Standards</b>	4 x Dual-band WLAN 2.4/5 GHz
	<b>Specification</b>	<b>Frequency</b> 2400 - 2500, 5180 - 5835 <b>Gain</b> 7,5 dBi (WLAN 2.4) / 8,3 dBi (WLAN 5) (connector a and c) 8,2 dBi (WLAN 2.4) / 8,5 dBi (WLAN 5) (connector b and d) <b>VSWR</b> ≤ 1,8 typ. <b>Impedance</b> 50 Ohm <b>Radiation</b> omnidirectional
	<b>Connectors</b>	<b>4x N female</b> <b>Type N</b> <b>Gender</b> Female
<b>Mechanical</b>	<b>Dimensions</b>	<b>Diameter</b> 200 mm <b>Height</b> 40 mm
	<b>Weight</b>	1000 g
	<b>Mounting</b>	Rooftop with screws
	<b>Color</b>	black
<b>Environment</b>	<b>Operating Temperature</b>	-40°C to +80°C
	<b>Ingress Protection Level</b>	IP42
<b>Certifications</b>	<b>Compliance</b>	EN 50155, EN 45545-2, ECE R118
	<b>Standards</b>	IEC 61373, 2014/30/EU; 2006/28/EC; 2002/95/EC
	<b>Domain</b>	Railway
<b>Extension Cables</b>	<b>WLAN</b>	4 x Ant-Cable-Railway-01 / 3 m / N male / TNC male
<b>Other</b>	<b>Order Code</b>	Antenna-Railway-Indoor-4W