

## XT-1E TOUCH BUTTON

---

### XT range

The nexmosphere X-Touch range is a family of touch button boards in various sizes and configurations that can be combined in one setup. The X-touch technology enables button placement hidden inside the display structure for seamless, non visible integration into the application. The technology works with multiple surface materials, such as acrylic, glass, carton, and wood. The button sensitivity and responsiveness can be adjusted by programming the Xperience controller accordingly.



The X-Touch 1E is a rectangular board with one medium-sized capacitive touch button.

### Features

- One small-sized capacitive touch button (20 mm)
- One bright controllable LED (W-version only)

### X-touch technology

- Works with multiple materials, such as acrylic, glass, carton, stone, and wood
- Compatible with any nexmosphere Xperience controller
- Powered and programmable by nexmosphere Xperience controller

### X-talk

The X-Touch boards can easily be connected to any of the nexmosphere Xperience controllers using the X-talk interface. All settings of the X-Touch are programmable on the controller, enabling a seamless integration in your application.

- Plug and smile interface
- Compatible with any nexmosphere Xperience controller
- Powered and programmable by nexmosphere Xperience controller

### Benefits

- Ultra flat (4 mm), easy to integrate
- Bright white indication LED (custom colors on request)
- 4 programmable options for LED output; on, off, slow, and fast blink
- Multiple data gathering functionalities on Xperience controller offer unique insight into how your application is being used
- Auto-calibration and auto-start for highly reliable applications (24/7)

# XT-1E TOUCH BUTTON

## Mounting specifications

- Keep clean from metal objects or surfaces
- Maximum material thickness: 1–8 mm, depending on the material
- Works on glass, acrylic, wood, cardboard, stone, and non-metallic materials

## Thermal specifications

Operating temperature: +10°C...+40°C/ +50°F ... +104°F  
 Storage temperature: -20°C...+50°C/ -4°F ... +122°F

## Electrical specifications

- Operating voltage: 5V DC (via X-talk interface)
- Power consumption: 10mA

## Miscellaneous

- Mounting holes for easy fixation
- Customized layouts and board shapes available on request
- 1-year warranty (optional 3-year extended warranty available)

## Packaging

Items per carton 1, 10 or 50 pcs

## Standards and Certifications



**RoHS**  
compliant

## Mechanical dimensions

LxWxH: 40 x 30 mm

Screw fixation: 33 x 20 mm

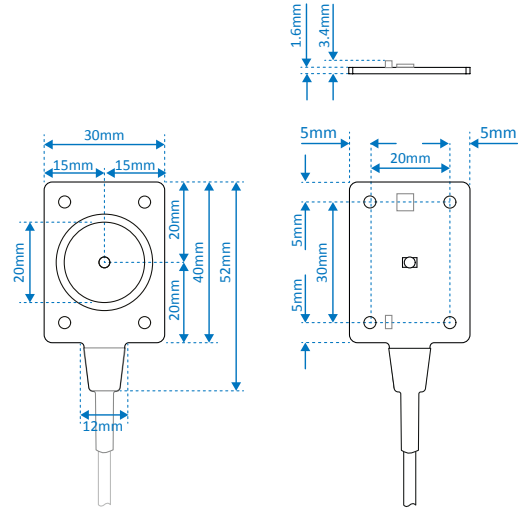

## Interfaces

1. Touch button 1 and button LED 1 (W-version only)

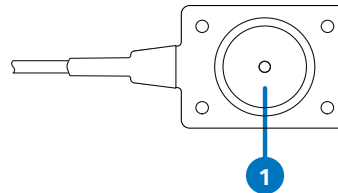

## Ordering information

Product ID	Description	Quantity
XT-1EW4	X-Touch, 1 small button, Rectangular, White LED, 60cm cable	1 pc
XT-1EW5	X-Touch, 1 small button, Rectangular, White LED, 120cm cable	1 pc
XT-1EW6	X-Touch, 1 small button, Rectangular, White LED, 180cm cable	1 pc
XT-1EN4	X-Touch, 1 small button, Rectangular, No LED, 60cm cable	1 pc
XT-1EN5	X-Touch, 1 small button, Rectangular, No LED, 120cm cable	1 pc
XT-1EN6	X-Touch, 1 small button, Rectangular, No LED, 180cm cable	1 pc

## Nexmosphere

High Tech Campus 10 (Mμ building)  
 5656 AE Eindhoven • The Netherlands

T +31 40 240 7070  
 E sales@nexmosphere.com

© 2017 Nexmosphere. All rights reserved. v1.0 / 11-18  
 All content contained herein is subject to change without prior notice.